



**SUPER  
SILENCED**

Soundproof canopy



Heavy duty



AVR

Super silenced generators equipped with Yanmar 1500 RPM engine. Compact and resistant, they are designed with on-board control panel and cover with security lock to ensure safe use, connector for automatic starting and three-phase and single-phase socket panel. Central lifting hook and forkable base allow a practical handling.



# US-Y SS-Y SERIES STANDARD EQUIPMENT



## U-SY SS-Y SERIES

Controller with digital display for full monitoring of generator parameters: generator voltage, mains voltage, battery voltage, ammeter, frequency, hourmeter, oil pressure, engine temperature, fuel level, fail to start; with auto engine protection shutdown system in case of: fail to start, emergency stop, low oil pressure, low fuel level, high coolant temperature, oil pressure sender open circuit, over/under voltage, over/ under frequency Starting battery

- Power outputs protections
- Earth Leakage Circuit Breaker (ELCB)
- Automatic voltage regulator (AVR)
- Connector for ATS panel and remote control
- Engine oil drain pipe
- Three-way valve
- Bundled tank
- Particulate filter (MG 35-50 SS-Y Stage V)
- Fork lift pockets
- Lifting hook

Socket kit:

MG 16-23 U-SY: 3 single-phase 16 A - 230 V sockets, 1 three-phase 16 A - 400 V socket, 1 three-phase 32 A - 400 V socket

MG 35 SS-Y: 2 single-phase 16 A - 230V sockets, 3 single-phase 32 A - 230 V sockets, 1 three-phase 32 A - 400 V socket, 1 three-phase 63 A - 400 V socket

50 SS-Y: 2 single-phase 16 A - 230 V sockets, 4 single-phase 32 A - 230 V sockets, 1 three-phase 32A - 400 V socket, 1 three-phase 63A - 400V socket

## DIMENSIONS IN MM

### MG 16-23 US-Y

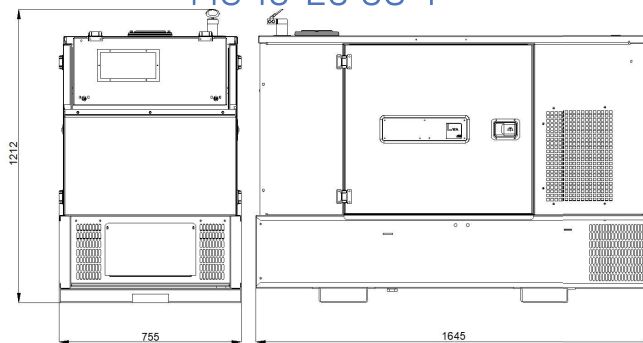

### MG 35-50 SS-Y

### MG 35-50 SS-Y STAGE V

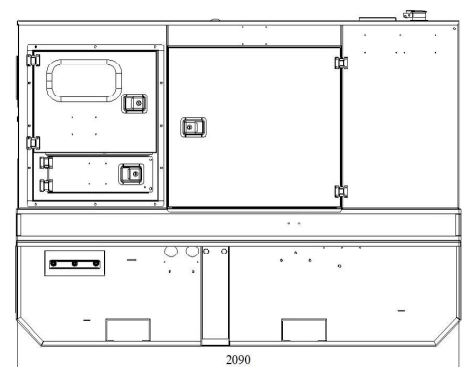
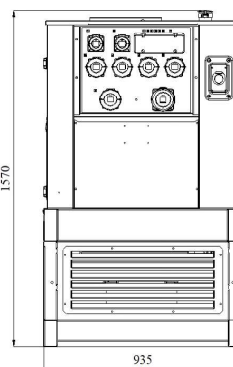
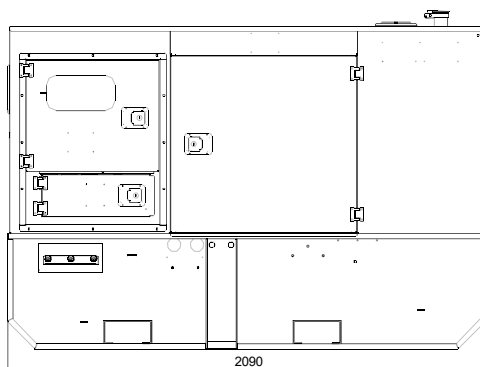
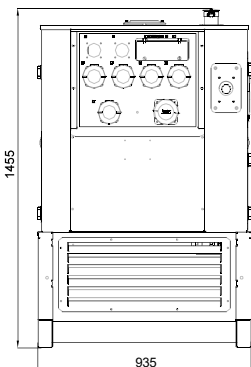

# US-Y SS-Y SERIES

# TECHNICAL DATA

|                         | MG 16 US-Y<br>Stage V | MG 23 US-Y<br>Stage V | MG 35 SS-Y<br>Stage 0 | MG 35 SS-Y<br>Stage V | MG 50 SS-Y<br>Stage 0 | MG 50 SS-Y<br>Stage V |
|-------------------------|-----------------------|-----------------------|-----------------------|-----------------------|-----------------------|-----------------------|
| Noise level<br>Lwa      | 92 (67 dB a 7 mt)     |                       |                       | 93 (68 dB a 7 mt)     | 92 (67 dB a 7 mt)     | 93 (68 dB a 7 mt)     |
| AC generator-50Hz       | Synchronous           |                       |                       |                       |                       |                       |
| Three-phase max. power  | 16 kVA - 400 V        | 22 kVA - 400 V        | 33 kVA - 400 V        |                       | 44 kVA - 400 V        |                       |
| Single-phase max. power | 5,3 kVA - 230 V       | 7,3 kVA - 230 V       | 11 kVA - 230 V        |                       | 14,7 kVA - 230 V      |                       |
| Power Factor            | cos φ 0,8             |                       |                       |                       |                       |                       |
| Yanmar 1500 RPM engine  | 3 TNV 88              | 4 TNV 88              | 4 TNV 98              |                       | 4 TNV 98 T            |                       |
| Fuel                    | Diesel                |                       |                       |                       |                       |                       |
| No. cylinders           | 3                     | 4                     | 4                     |                       | 4                     |                       |
| Power                   | 18,1 HP(13,5 kWm)     | 24,1 HP(18 kWm)       | 46,1 HP (34,4 kWm)    |                       | 55,9 HP (41,7 kWm)    |                       |
| Displacement            | 1642 cm <sup>3</sup>  | 2190 cm <sup>3</sup>  | 3319 cm <sup>3</sup>  |                       | 3319 cm <sup>3</sup>  |                       |
| Cooling system          | Water                 |                       |                       |                       |                       |                       |
| Starting system         | Electric              |                       |                       |                       |                       |                       |
| Fuel tank capacity      | 70 lt                 |                       |                       | 140 lt                |                       |                       |
| Fuel consumption @75%   | 2,7 lt/h              | 3,5 lt/h              | 6,4 lt/h              |                       | 8,1 lt/h              |                       |
| Insulation Class        | H                     |                       |                       |                       |                       |                       |
| Ambient temperature     | 40 °C                 |                       |                       |                       |                       |                       |
| Altitude                | 1000 mt               |                       |                       |                       |                       |                       |
| Degree of protection    | IP 23                 |                       |                       |                       |                       |                       |
| Dimensions<br>(LxWxH)   | 1645x755x1212 mm      |                       | 2090x935<br>x1455 mm  | 2090x935<br>x1570 mm  | 2090x935<br>x1455 mm  | 2090x935<br>x1570 mm  |
| Dry weight              | 580 kg                | 610 kg                | 940 kg                | 950 kg                | 1020 kg               | 1030 kg               |



## US-Y SS-Y SERIES

Options on request

- 1- Engine heater
- 2- Automatic refill system
  - Spark arrester muffler
  - 300 lt fuel tank\*
- Increased alternator (30kVA)\*\*

Accessories

- 3- ATS panel with mains sensor
- 4- Remote control
- GRT2W: 2 wheels site trailer

\* MG 35 - 50 SS-Y

\*\* MG 23 US-Y

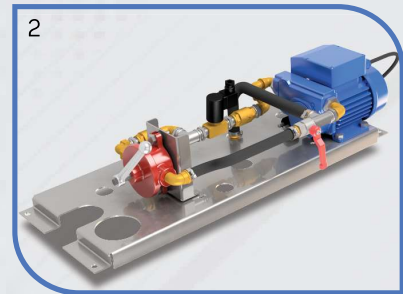

### NOTE

---

---

---

---

---

---

