



Assembly kit
 Montagesatz
 Kit de montage
 Kit de montaje
 Kit de montagem
 Kit di montaggio
 Montageset
 Montagesæt
 Monteringsatts



**ROOF CUT
 (FLAT ROOF WITH GAP)
 101.00704-1**

ITALCOLVEN srl
 Via G. Rossini, 50
 59013 Montemurlo - Prato - Italia

Tel.: +39 0574870516
 Fax: +39 0574870509

www.italcolven.com
 www.viesakompressor.com
 info@italcolven.com

REV.01

Date 13.05.21



101.00711-6



- Verificare gli spazi d'ingombro attorno all'unità e mascherina prima di effettuare il taglio.
- Il kit può essere installato soltanto su un **tetto a superficie piana** e con un intercapedine **minimo di 25mm** , così da permettere il corretto montaggio del telaio di fissaggio.
- Check the clearance spaces around the unit and the mask before making the cut.
- The kit can only be installed on a **flat surface roof** and with an air gap of **minimum 25mm** , so as to allow the correct assembly of the fixing frame.
- Verifique el espacio libre alrededor del equipo y del cubretapizado antes de realizar el corte.
- El kit solo se puede instalar en un **techo plano** y con un espacio entre el techo i tapizado de **mínimo de 25 mm** , para permitir el correcto montaje del marco de fijación.
- Vérifiez les espaces d'encombrement autour de l'unité et du masque avant d'effectuer la coupe.
- Le kit ne peut être installé que sur un **toit à surface plane** avec un interstice **minimum de 25 mm** , de manière à permettre le montage correct du cadre de fixation.

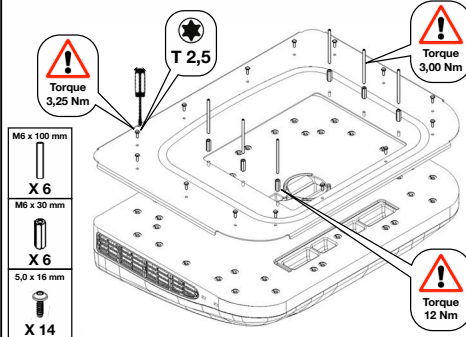
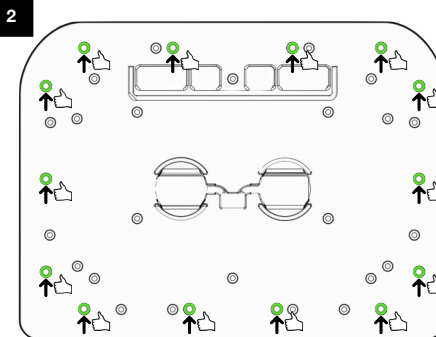
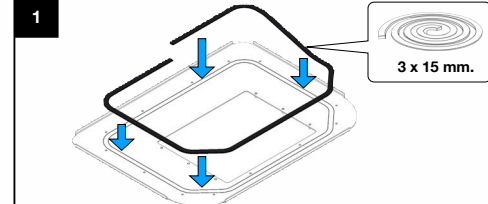
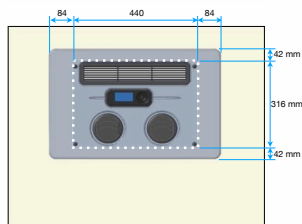
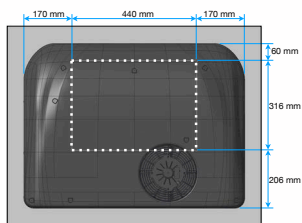
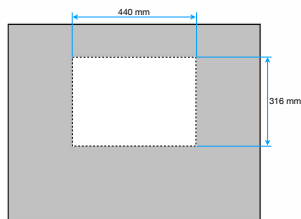
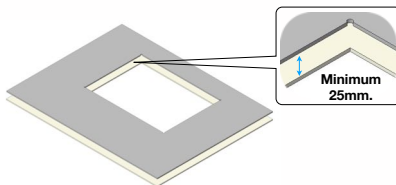

3

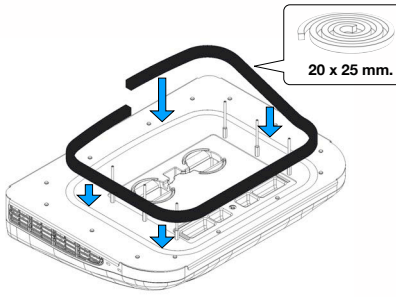

4

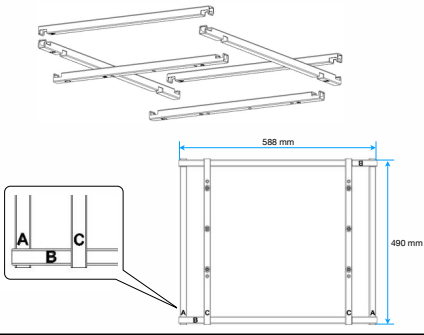

5

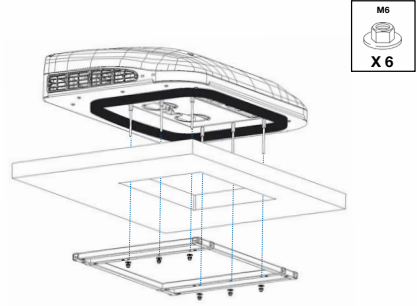

6

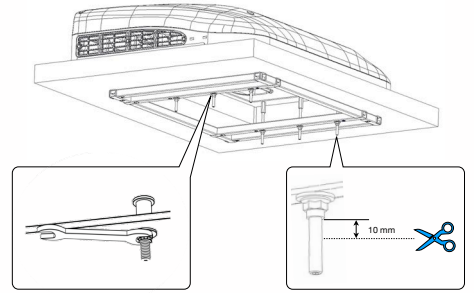

7

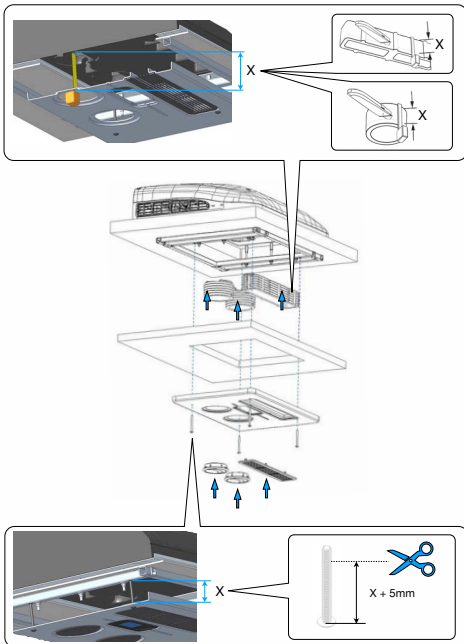

8

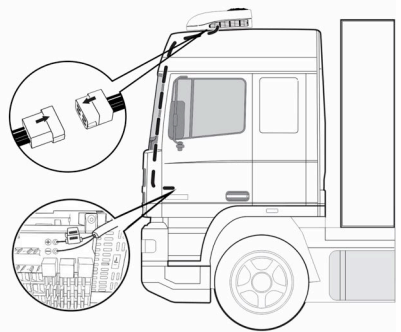

9

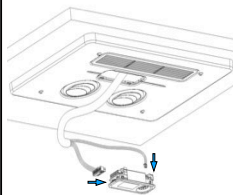

10

