

English

1	Important notes.....	3
2	Explanation of symbols.....	3
3	Explanation of symbols on the device.....	4
4	Safety instructions.....	4
5	Scope of delivery.....	6
6	Intended use.....	6
7	Technical description.....	7
8	Operation.....	10
9	Cleaning and maintenance.....	17
10	Troubleshooting.....	20
11	Warranty.....	22
12	Disposal.....	22
13	Technical data.....	23

1 Important notes

Please read these instructions carefully and follow all instructions, guidelines, and warnings included in this product manual in order to ensure that you install, use, and maintain the product properly at all times. These instructions **MUST** stay with this product.

By using the product, you hereby confirm that you have read all instructions, guidelines, and warnings carefully and that you understand and agree to abide by the terms and conditions as set forth herein. You agree to use this product only for the intended purpose and application and in accordance with the instructions, guidelines, and warnings as set forth in this product manual as well as in accordance with all applicable laws and regulations. A failure to read and follow the instructions and warnings set forth herein may result in an injury to yourself and others, damage to your product or damage to other property in the vicinity. This product manual, including the instructions, guidelines, and warnings, and related documentation, may be subject to changes and updates. For up-to-date product information, please visit documents.domestic.com.

2 Explanation of symbols

A signal word will identify safety messages and property damage messages, and also will indicate the degree or level of hazard seriousness.



WARNING!

Indicates a hazardous situation that, if not avoided, could result in death or serious injury.



CAUTION!

Indicates a hazardous situation that, if not avoided, could result in minor or moderate injury.



NOTICE!

Indicates a situation that, if not avoided, can result in property damage.



NOTE Supplementary information for operating the product.

3 Explanation of symbols on the device



Warning! Risk of fire. Flammable materials.

4 Safety instructions

General safety



WARNING! Electrocutation hazard

- > Installation and removal of the refrigerator may only be carried out by qualified personnel.
- > Installation in washrooms and areas exposed to water must be performed by a qualified technician.
- > If installing the refrigerator under a canopy or similar environment, ensure that the refrigerator is protected from rain and splashing water.
- > Do not operate the refrigerator if it is visibly damaged.
- > This refrigerator may only be repaired by qualified personnel. Improper repairs can result in considerable danger or damage to the refrigerator.
- > If the power cable for this refrigerator is damaged, it must be replaced by the manufacturer, customer service or a similarly qualified person in order to prevent safety hazards.
- > When positioning the refrigerator, ensure the supply cord is not trapped or damaged.
- > Do not touch exposed cables with your bare hands.



WARNING! Fire hazard

- > The refrigerant in the refrigerant circuit is highly flammable and in the event of a leakage combustible gases could build up if the appliance is in a small room. In the event of any damage to the refrigerant circuit:
 - Keep naked flames and potential ignition sources away from the refrigerator.
 - Ventilate the room well.
 - Switch off the refrigerator.
- > For refrigerators with flammable refrigerant: The refrigeration circuit contains a small quantity of an environmentally friendly but flammable refrigerant. It does not damage the ozone layer and does not increase the greenhouse effect. Any leaking refrigerant may ignite.
- > For refrigerators with flammable refrigerant: Do not use or store the refrigerator in confined spaces with none or minimal air flow.
- > The insulation of the refrigerator contains flammable cyclopentane and requires special disposal procedures. Deliver the refrigerator at the end of its life-cycle to an appropriate recycling center.



WARNING! Explosion hazard

Do not store any explosive substances, such as aerosol cans with propellants, in the refrigerator.



WARNING! Health hazard

- > This refrigerator can be used by children aged from 8 years and above and persons with reduced physical, sensory or mental capabilities or lack of experience and knowledge if they have been given supervision or instruction concerning use of the refrigerator in a safe way and understand the hazards involved.
- > Children aged from 3 to 8 years are allowed to load and unload the refrigerator.
- > Cleaning and user maintenance shall not be made by children without supervision.

- > Children must be supervised to ensure that they do not play with the refrigerator.



WARNING! Risk of child entrapment

- > Ensure that the shelves are mounted and secured so that children cannot lock themselves in the refrigerator.
- > Before disposing of your old refrigerator:
 - Dismantle the drawers.
 - Leave the shelves in the refrigerator so that children cannot climb inside.
- > Take off the doors.



CAUTION! Health hazard

- > To avoid a hazard due to instability of the refrigerator, it must be fixed in accordance with the installation instructions.
- > Keep ventilation openings, on the refrigerator and in its enclosure or in the built-in structure, clear of obstruction.
- > Do not use mechanical devices or other means to accelerate the defrosting process, other than those recommended by the manufacturer.
- > Do not open or damage the refrigerant circuit under any circumstances.
- > Do not use electrical devices inside the refrigerator unless they are recommended by the manufacturer for that purpose.



CAUTION! Risk of injury

- > Do not use or store flammable materials in or near this refrigerator.
- > Do not place articles on or against this refrigerator.
- > Do not modify this refrigerator.



NOTICE! Damage hazard

- > If present, keep the condensate drain clean at all times.
- > If the refrigerator has ventilation grilles, do not use a high-pressure cleaner near the ventilation grille when cleaning the vehicle.
- > The refrigerator shall not be exposed to rain.
- > Never pull the plug out of the socket by the connection cable.

Operating the refrigerator safely



CAUTION! Health hazard

- > Ensure to put only items in the refrigerator which may be chilled at the selected temperature.
- > Clean regularly surfaces that can come in contact with food and accessible drainage systems.
- > Store raw meat and fish in suitable containers in the refrigerator, so that it is not in contact with and cannot drip onto other food.
- > Opening the door for long periods can cause a significant increase of the temperature in the compartments of the refrigerator. If the refrigerator is left empty for long periods:
 - Switch off the refrigerator.
 - Defrost the refrigerator.
 - Clean and dry the refrigerator.
 - Leave the door open to prevent mold developing within the refrigerator. If available, put the refrigerator door and the freezer door into the winter position.

**CAUTION! Risk of injury**

- > Do not put your fingers into the hinge.
- > Close and latch the refrigerator door before beginning a journey.
- > The cooling system at the back of the refrigerator becomes very hot during operation. If the refrigerator is equipped with ventilation grilles, protect yourself from contact with hot parts when removing the ventilation grilles.
- > The device door or the freezer door can completely detach from the device if used incorrectly. Push the doors closed until you hear a clear click at the top and bottom.

**NOTICE! Damage hazard**

- > Do not lean on the open refrigerator door.
- > Store heavy objects such as bottles or cans only in the refrigerator door, in the vegetable compartment or on the bottom shelf.
- > If the refrigerator has a double-sided door and the door is not locked correctly on the opposite side, push on that side at the top and the bottom until it locks in place.
- > **Danger of overheating!** Always ensure sufficient ventilation so that the heat generated during operation can dissipate. Ensure that the refrigerator is sufficiently far away from walls and other objects so that the air can circulate.
- > Do not fill the interior with ice or fluid.
- > Protect the refrigerator and the cable against heat and moisture.
- > Never pull the plug out of the socket by the connection cable.

**NOTE**

- > If the battery management system of your vehicle shuts down the refrigerator to protect the battery, contact your vehicle manufacturer.
- > For ambient temperatures of 15 °C ... 25 °C select the average temperature setting.
- > If the door is not locked correctly on the opposite side, push on that side at the top and the bottom until it locks in place.
- > To avoid food waste, note the following:
 - Keep temperature fluctuation as low as possible. Only open the freezer as often and for as long as necessary. Store the foodstuff in such a way that the air can still circulate well.
 - Ensure to put only items in the refrigerator which may be chilled at the selected temperature.
 - Store the different foodstuff types as shown in the figures.
 - If the temperature can be adjusted: Adjust the temperature to the quantity and type of the foodstuff.
 - Foodstuff can easily absorb or release odor or taste. Always store foodstuff covered or in closed containers/bottles.

5 Scope of delivery

Quantity	Description
1	Compressor refrigerator
1	Short operating manual
1	Operating manual (online only)
1	Installation manual

6 Intended use

The refrigerator is intended for:

- Installation in caravans, motor homes, and trucks
- Cooling and storing food
- Storing prefrozen food
- Indoor use

This refrigerator is not intended for commercial, retail or household applications.

The refrigerator is **not** suitable for:

- Installation in a marine environment, e.g. on boats
- Storing medications
- Storing corrosive substances or substances that contain solvents
- Quick-freezing food
- Outdoor use

When used on boats, the device shall be installed in a dayroom area and not open deck.

The frozen compartment is suitable for storing pre-frozen food, storing or making ice cream and making ice cubes. It is not suitable for freezing previously unfrozen food.

The refrigerator is intended for installation in a piece of cabinetry or an installation niche.

Optimum cooling performance is provided at ambient temperatures between 16 °C ... 43 °C and at a maximum humidity of 90 % .

This product is only suitable for the intended purpose and application in accordance with these instructions.

This manual provides information that is necessary for proper installation and/or operation of the product. Poor installation and/or improper operation or maintenance will result in unsatisfactory performance and a possible failure.

The manufacturer accepts no liability for any injury or damage to the product resulting from:

- Incorrect installation, assembly or connection, including excess voltage
- Incorrect maintenance or use of spare parts other than original spare parts provided by the manufacturer
- Alterations to the product without express permission from the manufacturer
- Use for purposes other than those described in this manual

Dometic reserves the right to change product appearance and product specifications.

7 Technical description

The refrigerator is a compressor refrigerator.

The refrigerator is suitable for use with a 12 V or 24 V DC voltage and can therefore also be used for camping or on boats.

The model is factory fitted with a frozen compartment, which can be removed and reinstalled.

The refrigerator door has a latching mechanism to protect it during transport.

All materials used in the refrigerator are compatible for use with foodstuffs.

Description of the device

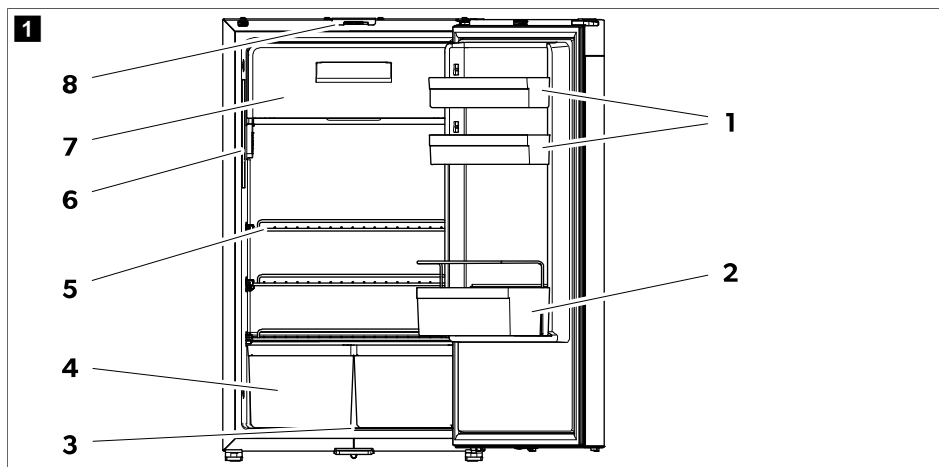

No.	Explanation
1	Door shelf
2	Bottle shelf
3	Condensate drain
4	Crisper
5	Cabinet shelf
6	Control panel with display
7	Frozen compartment
8	Door latch for ventilation

Control and display elements

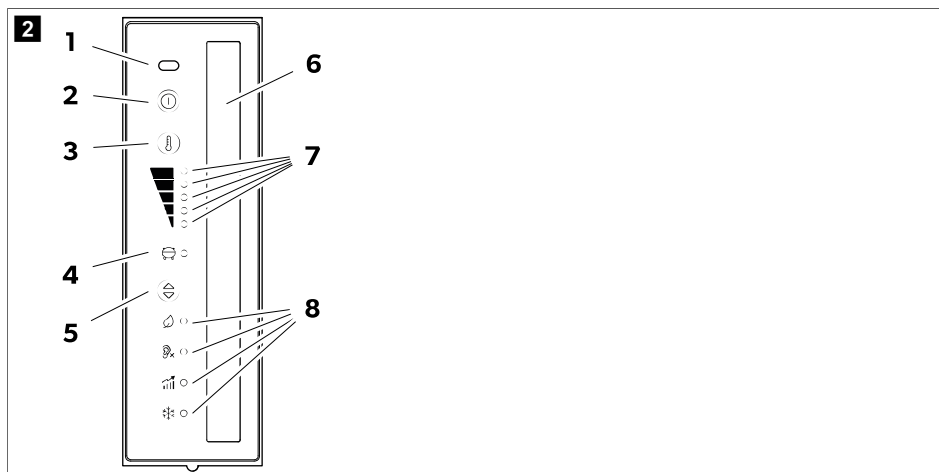

No.	Explanation
1	IR door opening sensor
2	Ⓞ ON/OFF button
3	Ⓜ Cooling level setting button
4	Compressor and error indicator LED
5	Ⓢ Operation mode button
6	Interior lighting
7	Cooling level indicator LEDs  <ul style="list-style-type: none"> ■ Cooling Level 5 ■ Cooling level 4 ■ Cooling level 3 ■ Cooling level 2 ▼ Cooling level 1
8	Operation mode indicator LEDs





Compressor and error indicator LED

The compressor and error indicator LED displays the operating status of the compressor or indicates an error:

Color	Description
Blue	Compressor on
Orange	Compressor off
Red	Error (see chapter Error indication on page 22)

Operation mode indicator LEDs

The operation mode indicator LEDs display the following setting options:

Symbol	Description
	ECO mode: Operation with reduced energy -consumption. Cooling level 1 – 3
	QUIET mode: Operation with reduced noise level. Cooling level 1 – 4
	PERFORMANCE mode: Cooling level 1 – 5
	FREEZER mode: Operation with frozen compartment removed. Cools down the complete interior of the refrigerator to -5°C .

8 Operation

8.1 Before first use



NOTE

- > Do not store goods in the refrigerator for the first 4 hours after start-up.
- > When using the refrigerator for the first time, there may be a mild odor which will disappear after a few hours. Air out the living space well.
- > The cooling capacity can be affected by:
 - The ambient temperature (e.g. when the vehicle is exposed to direct sunlight)
 - The amount of food to be refrigerated
 - How often the door is opened
- > Clean the inside of the refrigerator for hygienic reasons (see [Cleaning and maintenance](#) on page 17).
- > Park the vehicle so that it is level, especially when starting up and filling the refrigerator before setting off on a journey.

8.1.1 Adjusting the door latch

The door latch on the top of the refrigerator can be adjusted to regulate the closing width of the door.

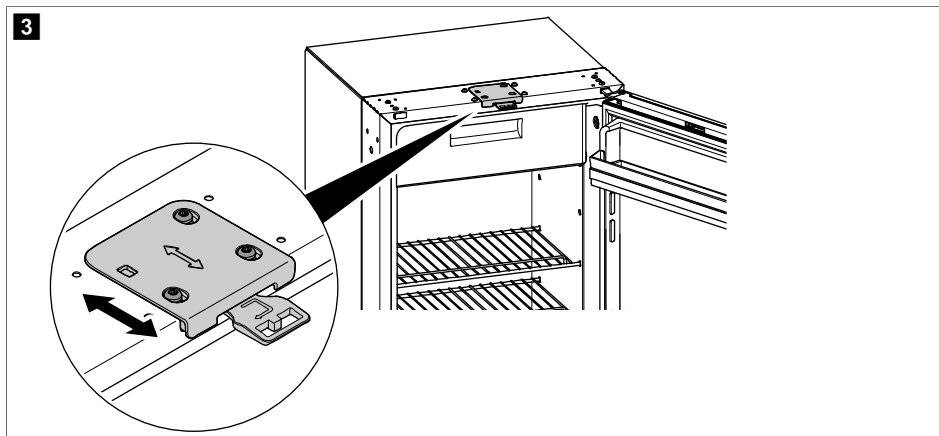

i **NOTE** Check whether the adjustable door latch is installed. If necessary, order the adjustable door latch (dometic.com) and replace the fixed door latch with the adjustable door latch.

> The door latch is set to position **A** at the factory. Move the door latch to position **B**.

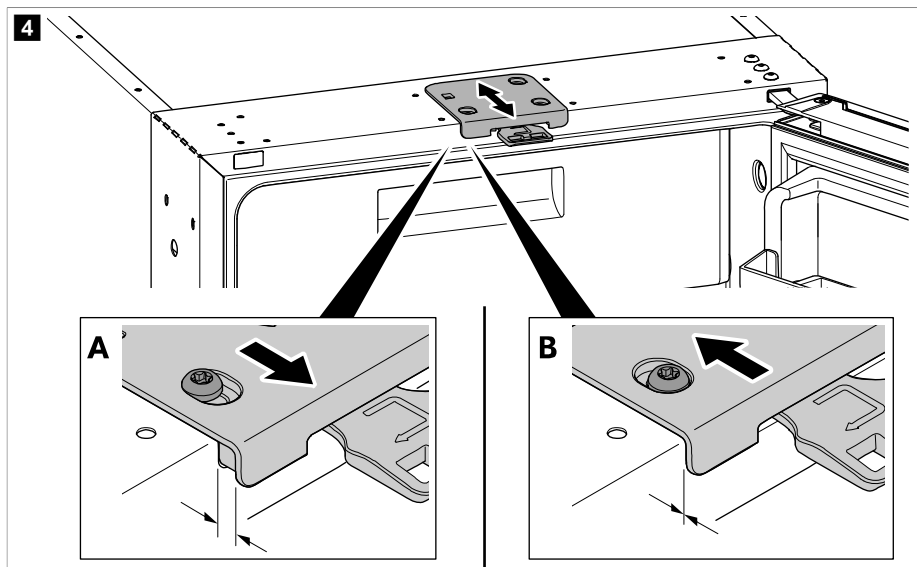

i **NOTE** If the door latch is in position **B**, ensure that the door latches properly when closing (see chapter Closing and securing the refrigerator door on page 13).

8.2 Information on storing food



CAUTION! Health hazard

If the refrigerator is exposed to an ambient temperature below 10 °C for an extended period of time, regulation of the frozen compartment temperature can no longer be guaranteed. That may cause the temperature of the frozen compartment to increase and the stored goods to be defrosted.



NOTICE! Damage hazard

- > Observe the maximum load per door shelf and door when filling the refrigerator (see Technical data).
- > Do not keep carbonated drinks in the frozen compartment.

To avoid food waste, note the following:

- Keep temperature fluctuation as low as possible. Only open the refrigerator as often and for as long as necessary. Store the foodstuff in such a way that the air can still circulate well.
 - Adjust the temperature to the quantity and type of the foodstuff.
 - Store the different foodstuff types as shown in the figures.
 - Foodstuff can easily absorb or release odor or taste. Always store foodstuff covered or in closed containers/bottles.
- > Store food as shown.

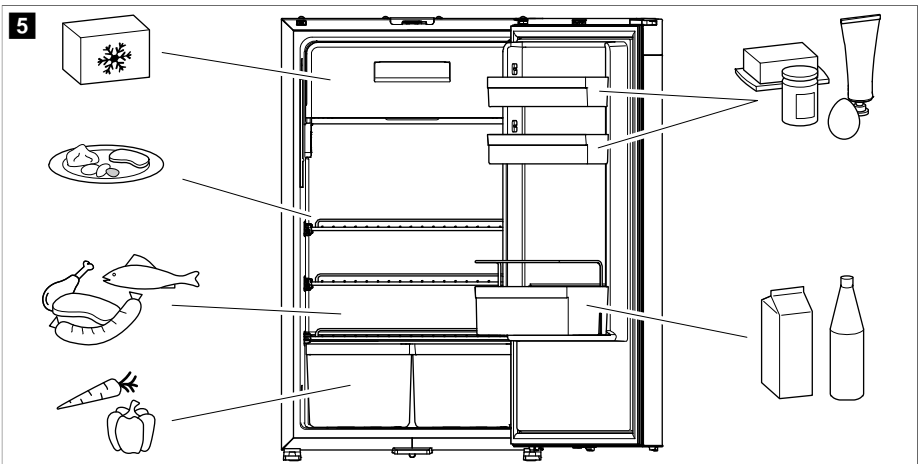

8.3 Saving energy

- Only open the refrigerator as often and for as long as necessary.
- Allow warm food to cool down first before placing it in the device to keep cool.
- Defrost your refrigerator as soon as a layer of ice forms.
- Avoid unnecessarily low temperature settings.
- For optimal energy consumption, position the shelves and drawers according to their position on delivery.
- On a regular basis, ensure the door seal still fits properly.
- Clean dust and dirt from the condenser at regular intervals.

8.4 Using the refrigerator door



CAUTION! Risk of injury

The refrigerator door and the frozen compartment door can completely detach from the device if used incorrectly.

8.4.1 Opening the refrigerator door



NOTE Ensure to pull the handle on the opposite side to the door stop. Note the respective position of the slider. Refer to the associated installation manual.

> To open the refrigerator door proceed as shown.

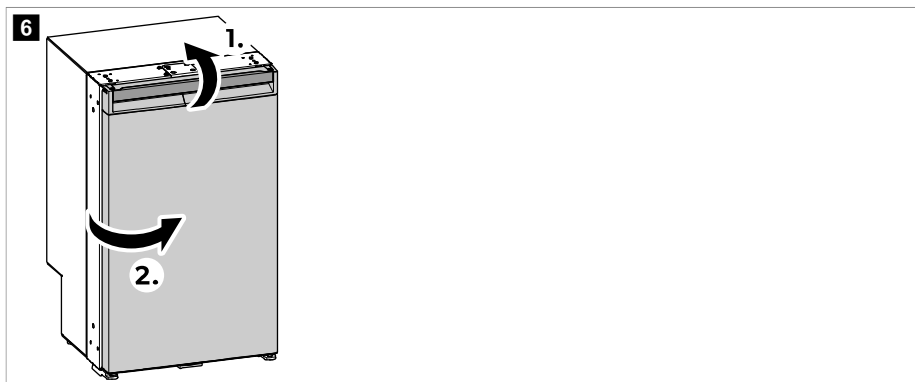

8.4.2 Closing and securing the refrigerator door



CAUTION! Risk of injury

If the door is not secured correctly, carefully push on the top and bottom of the door until it is secured in place.



NOTE The refrigerator door has a latching mechanism which is also used to protect it during transport.

- ✓ Press the door shut until you clearly hear it click at the top and bottom.

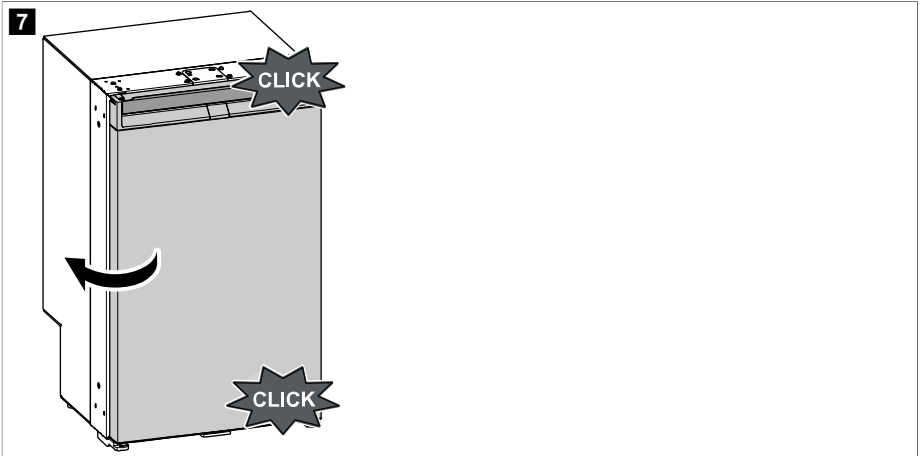



- ✓ The door is now closed and secured.

8.5 Switching on and off



NOTE Always switch off the refrigerator if it will not be used for a prolonged period of time.

- To switch on, press and hold the  button once for at least 2 s .
- ✓ The refrigerator switches on with the last selected cooling level setting and operation mode.
- To switch off, press and hold the  button for at least 2 s .

8.6 Setting the operation modes



NOTE When using the ECO, PERFORMANCE or FREEZER mode the system stays in this mode until further changes.

- To set the operation mode, press the  button repeatedly until the operation mode indicator LED for the desired operation mode lights up.

The following operation modes are available:

Using the ECO mode

With the ECO mode activated the refrigerator operates with reduced energy consumption at cooling levels 1 – 3.

- ✓ The operation mode indicator LED for the ECO mode () and the selected cooling level indicator LED light up.

Using the QUIET mode

With the QUIET mode activated the refrigerator operates with reduced noise level at cooling levels 1 – 4.

**NOTE**

- > The QUIET mode is not available if the refrigerator is running in FREEZER mode.
- > When using the QUIET mode the refrigerator will stay in this mode for 8 h and then return to the previously selected mode (ECO or PERFORMANCE mode).

- ✓ The operation mode indicator LED for the QUIET mode () and the selected cooling level indicator LED light up.

Using the PERFORMANCE mode

With the PERFORMANCE mode activated the refrigerator operates in standard mode at cooling levels 1 – 5.

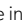
- ✓ The operation mode indicator LED for the PERFORMANCE mode () and the selected cooling level indicator LED light up.

Using the FREEZER mode

With the FREEZER mode activated the complete interior of the refrigerator is cooled to -5°C .



NOTE Remove the frozen compartment to use the FREEZER mode.

- ✓ The operation mode indicator LED for the FREEZER mode () and all cooling level indicator LEDs light up continuously.

8.7 Setting the cooling level

- > To set the cooling level, press the  button repeatedly until the desired cooling level is reached.

8.8 Repositioning the shelves**WARNING! Risk of child entrapment**

All shelves are fixed in place to prevent children from climbing into the refrigerator.

- > Only remove the shelves for cleaning purposes.
- > Refit the shelves and secure them in place.



NOTE Remove the frozen compartment before repositioning the shelves for easier access to the rear shelf knobs.

- > To reposition the shelves as desired proceed as shown.

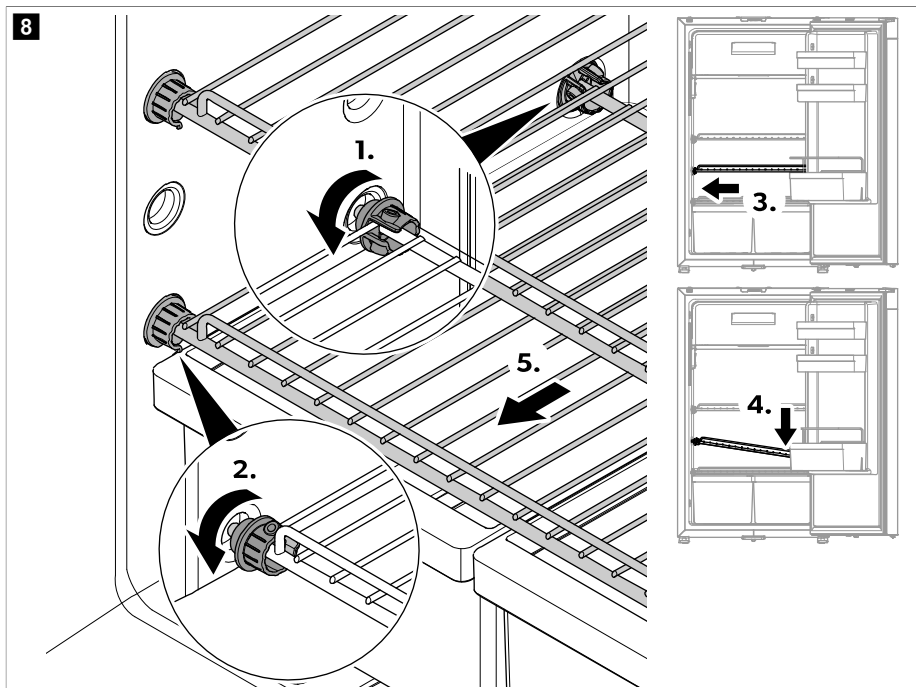

8.9 Removing the frozen compartment



NOTICE! Damage hazard

- > Close the frozen compartment door to remove the frozen compartment.
- > Grasp the frozen compartment by the bottom. Do not pull on the frozen compartment door.
- > Store the frozen compartment in a dry and safe place.

- > To remove the frozen compartment proceed as shown.

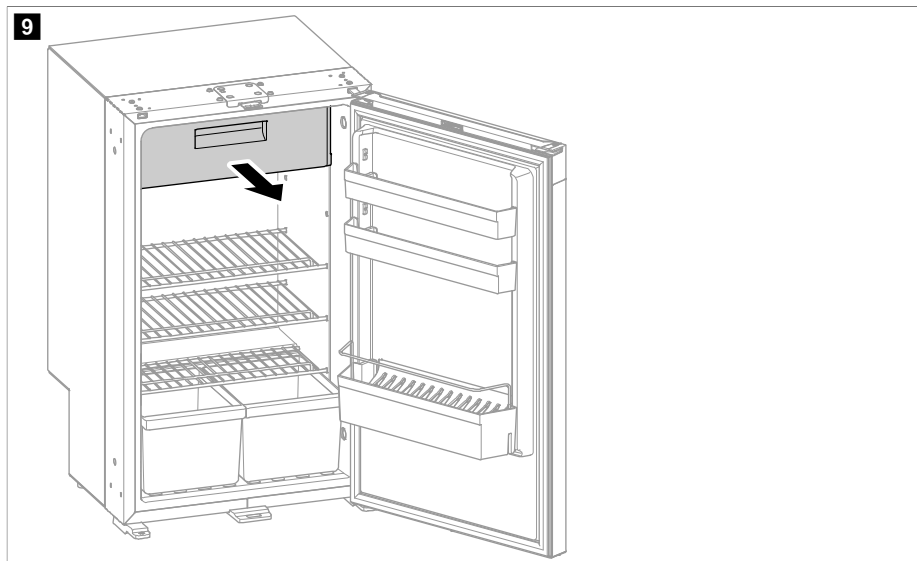

9 Cleaning and maintenance



WARNING! Electrocution hazard

Always disconnect the refrigerator from the energy supply before cleaning and maintenance.



NOTICE! Damage hazard

- > Do not use abrasive cleaning agents or hard objects during cleaning.
- > Never use hard or sharp tools to remove ice or to free frozen objects.
- > Ensure that no water drips into the seals. This can damage the electronics.



NOTICE! Damage hazard

The light source can only be replaced by the manufacturer, a service agent or similarly qualified person to avoid hazard.

- > Clean the interior and exterior of the refrigerator regularly with a damp cloth and as soon as it becomes dirty. Wipe the refrigerator dry with a cloth after cleaning.
- > Check the condensate drain regularly.
Clean the condensate drain when necessary. If it is blocked, the condensate collects on the bottom of the refrigerator.
- > Clean dust and dirt from the condenser regularly with a damp cloth.

Refrigerant circuit

The refrigerant circuit is maintenance-free.

Defrosting the refrigerator



NOTICE! Damage hazard

Do not use any mechanical tools or any other tools to speed up the defrosting process.



NOTE Over time, frost builds up on the back wall inside the refrigerator. If this layer of frost is about 3 mm thick, defrost the refrigerator.

> To defrost the refrigerator proceed as shown.

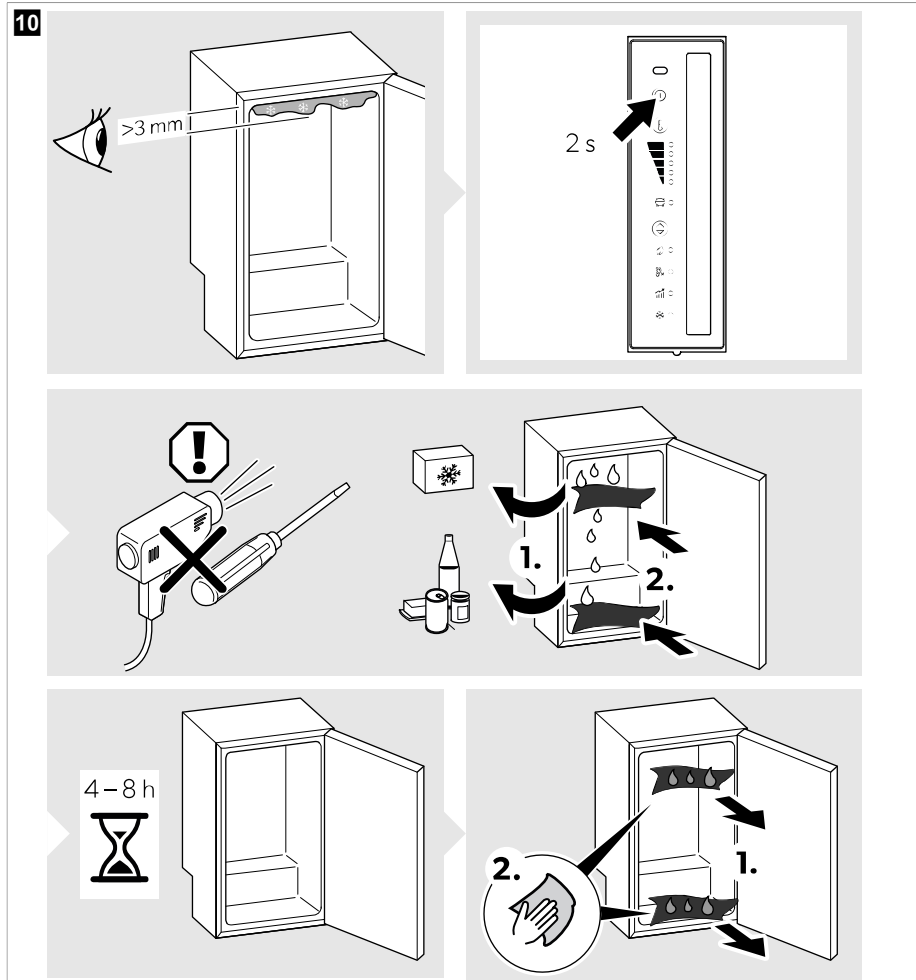

Positioning the refrigerator door into storage position

**CAUTION! Risk of injury**

The storage position may not be used while driving.



NOTE Put the refrigerator door into the storage position if you are not going to use the device for a longer period of time. This prevents mold from forming.

- > Defrost the refrigerator (see Defrosting the refrigerator on page 18).
- > Put the refrigerator door into storage position as shown.

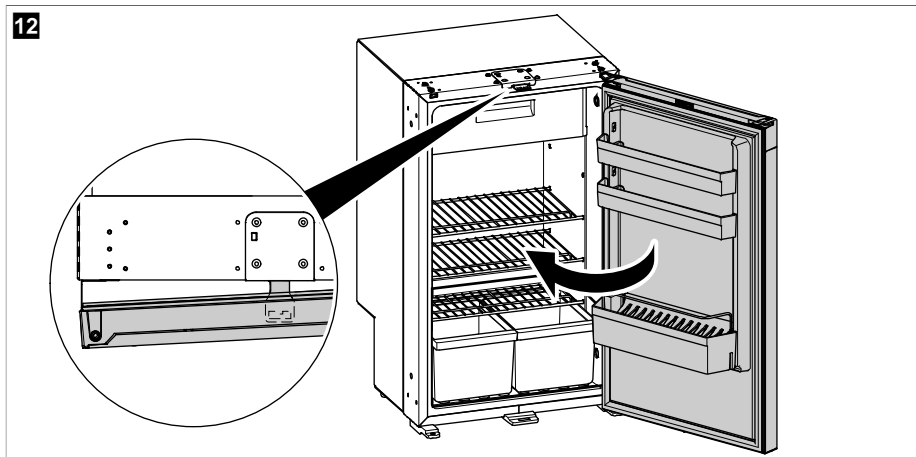
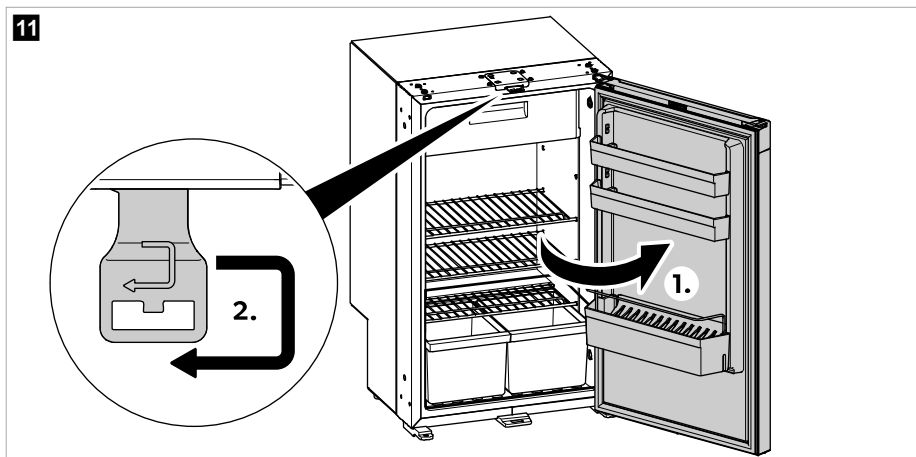



10 Troubleshooting

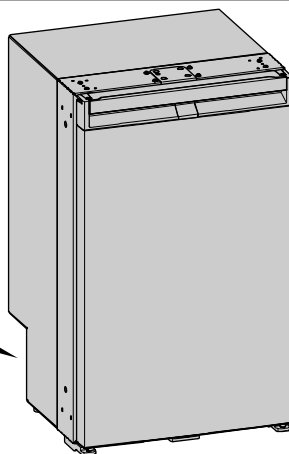
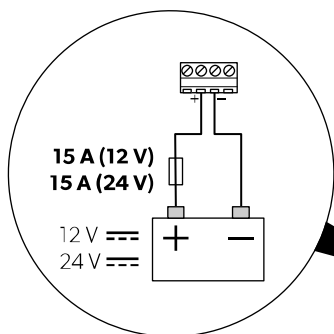

NOTE To safely operate 12 V consumer units in the caravan while driving, it must be ensured that the towing vehicle provides sufficient voltage. On some vehicles, the battery management system may automatically switch off the consumer units to protect the battery. Ask your vehicle manufacturer for more information.

13



Problem	Possible cause	Suggested remedy
The refrigerator does not work.	The fuse in the DC cable is defective.	> Replace the fuse ( Fig. 13 on page 20).
	The vehicle fuse has blown.	> Replace the vehicle fuse. Refer to the operating manual of your vehicle.
	The vehicle battery is discharged.	> Test the battery and charge it.
	The temperature at the compressor is too low (< 0 °C).	> Close/cover all external ventilation grilles completely with insulation material.
	The refrigerator switches off automatically if the voltage is insufficient. (Cut-off voltage: 10.4 V \Rightarrow)	> Load the battery. The refrigerator will start again automatically. (Cut-in voltage: 11.7 V \Rightarrow)
Poor cooling, increase in interior temperature. Compressor runs continuously.	The ventilation around the cooling unit is not sufficient.	> Check that the ventilation grille is not obstructed. > Move the refrigerator to another location.
	The interior walls are iced up.	> Check whether the refrigerator door closes properly. > Ensure that the refrigerator seal fits correctly and is not damaged.

Problem	Possible cause	Suggested remedy
		> Defrost the refrigerator (see Defrosting the refrigerator on page 18).
	The temperature is set too high.	> Set a lower temperature.
	The ambient temperature is too high.	> Remove the ventilation grille for a while so that warm air can escape quicker.
	Too much food was placed in the refrigerator at the same time.	> Remove some of the food.
	Too much warm food was placed in the refrigerator at the same time.	> Remove the warm food and leave it to cool down before putting it in again.
	The refrigerator has not been operating for very long.	> Check the temperature again after 4 h / 5 h .
	The condenser is dirty.	> Clean the condenser (see chapter Cleaning and maintenance on page 17).
	The fan is defective.	> Contact an authorized service agent.
Poor cooling, increase in interior temperature.	There is an interruption in the battery electronics connection.	> Establish a connection.
The compressor does not run (battery connection).	The main switch is defective (if installed).	> Replace the main switch.
	The additional supply line fuse has blown (if installed).	> Replace the supply line fuse.
	The battery voltage is too low.	> Charge the battery.
	The battery capacity too low.	> Replace the battery.
	The cables are loose. The contact is poor (corrosion).	> Establish a connection.
	The cable cross section is too small.	> Replace the cable.
	The compressor is defective.	> Contact an authorized service agent.
Unusual noises.	A component of the refrigerant circuit cannot move freely (touching the wall).	> Bend the component carefully away from the obstruction.
	There is a foreign object stuck between the cooling unit and the wall.	> Remove the foreign object.
	Fan noise.	> Contact an authorized service agent.
The door opens unintentionally when moving (e.g. while driving).	The door latch is set to position A (see chapter Adjusting the door latch on page 10).	> Set the door latch to position B .
The door does not close properly.	The door latch is set to position A (see chapter Adjusting the door latch on page 10).	> Set the door latch to position B .
	The door latch is set to position B (see chapter Adjusting the door latch on page 10).	> Ensure that the door latches properly when closing.

Problem	Possible cause	Suggested remedy
	page 10) but the door is not properly latched.	

Error indication



NOTE

- > All errors are indicated by the error indicator LED flashing red (see Control and display elements on page 9). The number of flashes depends on the type of fault. Each flash lasts for one quarter of a second. After the sequence of flashes a pause follows. The sequence for the fault is repeated every four seconds.
- > In ECO, PERFORMANCE, and FREEZER mode an additional beep sounds.

Flashing frequency	Error	Possible cause
1	Under or over voltage	The supply voltage is outside of the set range.
2	Excessive fan current	The fan load on the electronics unit is more than 1 A.
3	The motor does not start	The rotor is jammed. The pressure difference in the cooling system is too high.
4	Speed too low	If the cooling system is overloaded, the minimum speed of the motor cannot be maintained.
5	Overheating of the electronics unit	If the cooling system is loaded too heavily or the temperature is set too high, the electronics can overheat.
Constantly	Temperature sensor errors	Temperature sensor is defective.

11 Warranty

The statutory warranty period applies. If the product is defective, please contact the manufacturer's branch in your country (see dometic.com/dealer) or your retailer.

For repair and warranty processing, please include the following documents when you send in the device:

- A copy of the receipt with purchasing date
- A reason for the claim or description of the fault

Note that self-repair or nonprofessional repair can have safety consequences and might void the warranty.

12 Disposal



NOTICE! Damage hazard

The insulation of the cooling device contains flammable cyclopentane and requires special disposal procedures. Deliver the cooling device at the end of its life-cycle to an appropriate recycling center.



Place the packaging material in the appropriate recycling waste bins wherever possible. Consult a local recycling center or specialist dealer for details about how to dispose of the product in accordance with the applicable disposal regulations. Europe: The product can be disposed free of charge.

13 Technical data

For the current EU declaration of conformity for your device please refer to the respective product page on dometic.com or contact the manufacturer directly (see dometic.com/dealer).

This device complies with UN ECE Regulation R10.

	NRX0090V
Capacity	
• Refrigerator compartment	79 L
• Frozen compartment	8.4 L
• Total capacity	87 L
• Total capacity (frozen compartment removed)	92 L
Connection voltage	12 / 24 V ⁼⁼
Supply battery protection (12 V)	
• Cut-off voltage	10.4 V
• Cut-in voltage	11.7 V
Supply battery protection (24 V)	
• Cut-off voltage	22.8 V
• Cut-in voltage	24.2 V
Energy consumption	0.35 kWh / 24 h
Climate class	T
Storage temperature range	
• Refrigerator	0 °C ... 15 °C
• Frozen compartment	-12 °C ... -5 °C
• Freezer mode	-5 °C ± 2 °C
Intended ambient temperature use	16 °C ... 43 °C
Refrigerant	R600a
Refrigerant quantity	22 g
CO ₂ equivalent	0.000 t
Global warming potential (GWP)	3
Noise emission (EN60704)	
• PERFORMANCE mode	< 40 dB(A)
• QUIET mode	37 dB(A)
Dimensions H x W x D	821 mm × 486 mm × 480 mm
Net weight	22 kg