

OEM 300

Highly efficient LED floodlight designed to replace HID lighting in applications requiring high performance.

Electronic, LED control gear driving 64 LEDs at 1.4A with symmetric and asymmetric distribution. IP67, Class I protection with 10 kV Surge Protection.

Body: recyclable, extruded aluminium and powder-coated stainless steel. Optic Enclosure: PMMA Weather-proof lenses. Fully reversible mounting bracket supplied.

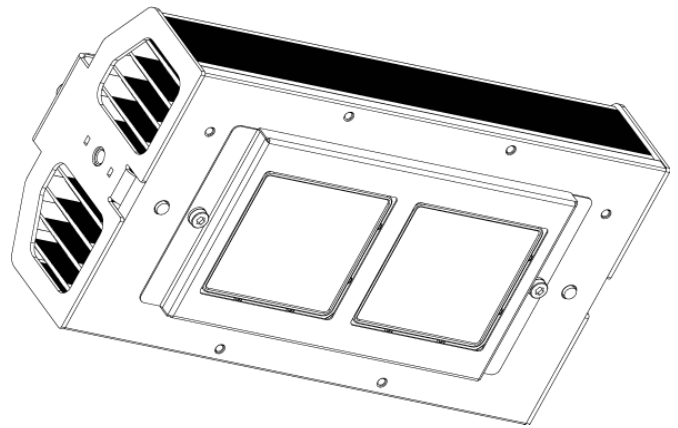

CE LED IP67 

Technical data

Performance

Nominal Flux:	36,300 lm
Net Flux:	33,505 lm
Power Absorption:	300 W

Optoelectronics

LED Type:	CREE XT-E
Circuit Board:	MPCB 1.6 mm
CRI:	70 / 80 / 90
Luminous Eff Loss:	< 1% per annum
Colour Temperature:	3,000K / 4,000K / 5,000K
Lumen Maintenance L90:	63,000h
Lumen Maintenance L70:	>100,000h

Optics

Secondary Lens:	TIR Lens Array
System Treatment:	IP67, Anti-yellowing
Available optics:	S1 / S2 / S3 / FH
No of LEDs per module:	32
No of modules:	2

Luminaire Body

Structure:	Stainless Steel
Metal coating:	Powder painted
Heatsinks:	Extruded Aluminium
Weight:	8,6kg
Installation angle:	Tilt Adjustment 360°
Dimensions:	376L x 201W x 179H mm
Windage Area:	0.0135m ²

Electronics

Voltage Input Range	100 - 305 VAC
	140 - 430 VDC
Power Factor	0.95

Surge Protection:	Line to Earth 10 kV; Line to Line 6 kV
Insulation Class:	IEC Class I
IP Rating:	IP 67
Short Circuit Protection:	Auto-recovery
Over Heat Protection:	Drops output current
Rel. Humidity Range:	0% - 94%
Operating Temp:	-40°C up to +65°C

Normative references

- EN 60598-1: 2015 - Luminaires - Part 1: General requirements and tests
- EN 60598-2-5: 2015 Luminaires - Part 2-5: Particular requirements - Floodlights
- EN 62031: 2008 + A2:2015 - LED modules for general lighting - Safety specifications
- EN 60598-2-3: 2003 + A1: 2011 - Luminaires - Part 2-3: Particular requirements - Luminaires for road and street lighting
- EN 62493: 2015 Assessment of lighting equipment related to human exposure to electromagnetic fields
- EN 60529: 1992 + A2: 2013 - Degrees of protection provided by enclosures (IP Code)
- IEC 60068-2-52: 1996 Environmental test - Part 2: Tests - Test Kb - Salt mist cyclic (sodium chloride solutions)
- EN 55015: 2013 + A1: 2015 - Limits and methods of measurement of radio disturbance characteristics of electrical lighting and similar equipment
- EN 61547: 2009 - Equipment for general lighting purposes - EMC immunity requirements
- EN 61000-3-2: 2014 - Electromagnetic compatibility (EMC) - Part 3-2: Limits - Limits for harmonic current emissions (equipment input current ≤ 16 A per phase)
- EN 61000-3-3: 2013 - Electromagnetic compatibility (EMC) - Part 3-3: Limits - Limitation of voltage changes, voltage fluctuations and flicker in public low-voltage supply systems, for equipment with rated current ≤ 16 A per phase and not subject to conditional connection
- EN 61643-11: 2012 - Low-voltage surge protective devices. Part 11: Surge protective devices connected to low-voltage power systems - Requirements and test methods
- IEEE C62.41.2-2002 - Recommended practice on characterization of surges in low-voltage AC power



Midstream Lighting Ltd, | Chesham Street, London SW1X 8ND, UK
Tel +44 207 584 8310 Email info@midstreamlighting.com
www.midstreamlighting.com



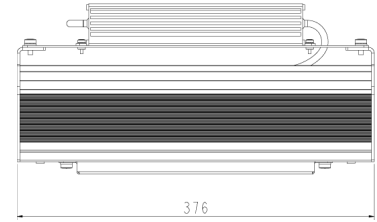
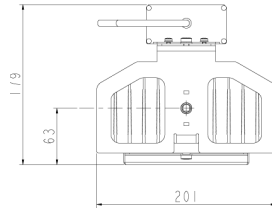
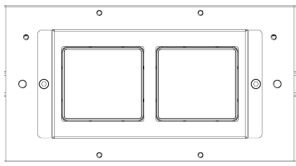

Photometrics

S1 (15° Symmetrical)

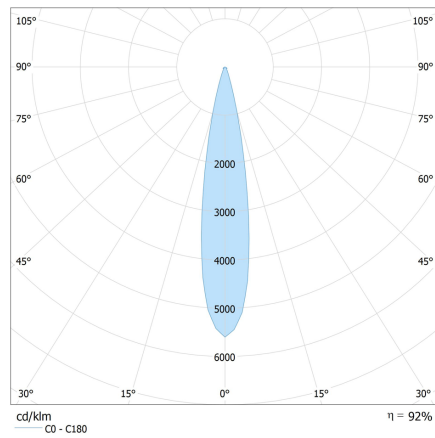

S2 (20° Symmetrical)

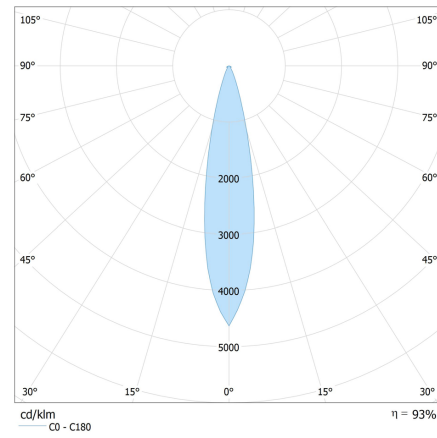

S3 (30° Symmetrical)

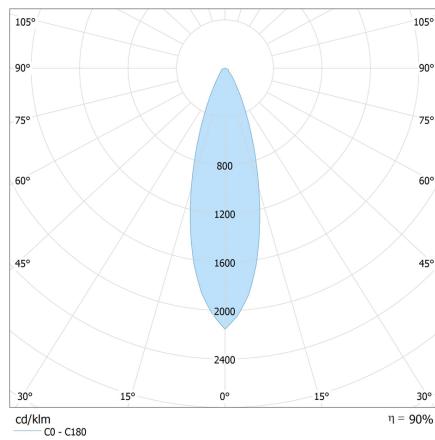

FH (Floodlight high asymmetry)

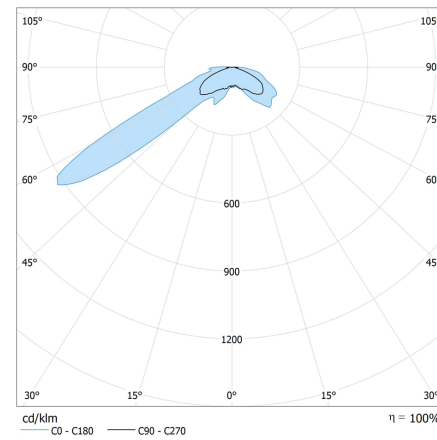

Ordering codes

Product Family	Power	Optic	CCT	CRI	Voltage	Body Type	Bracket
OEM	15	S1	A (5000K)	70	EU (100-305 AC)	T (Stainless Steel)	T (Flood)
	30	S2	B (4000K)	80			
		S3	C (3000K)	90			
		FH	D (5700K)				

Example: OEM-30-S3-A-70-EU-T-T-0000

Note: Specifications are subject to change without notice



Midstream Lighting Ltd, | Chesham Street, London SW1X 8ND, UK
 Tel +44 207 584 8310 Email info@midstreamlighting.com
 www.midstreamlighting.com

